

7.3 Diagnostic Data

By activating this function, you enable us to use data from your IVA app and your device for analysis purposes. With the help of this analysis data, for example information on system errors, we can continuously improve IVA and identify specific errors in the app.

To share your device's analytics data with us, the following steps are also necessary:

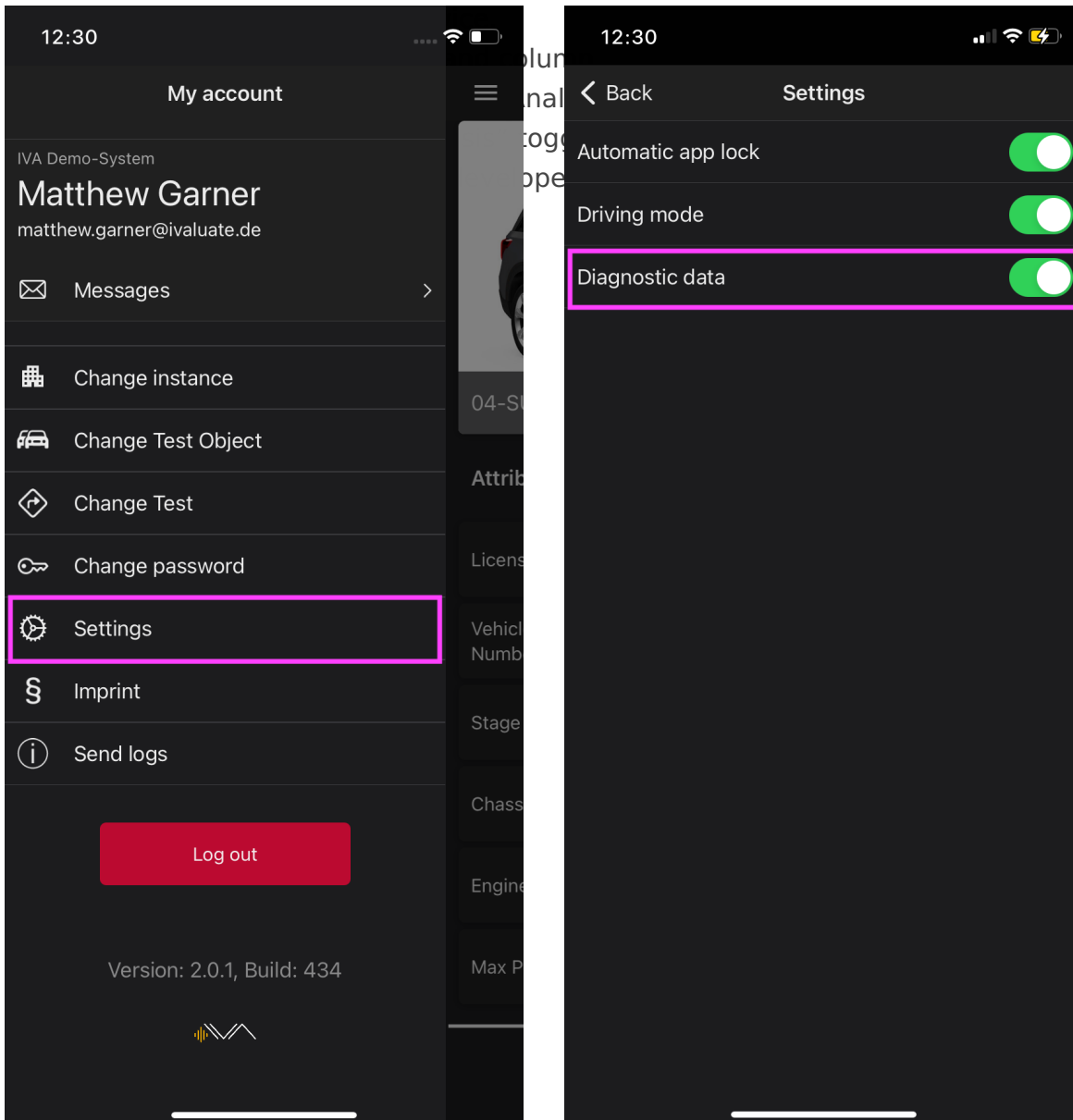

Revision #2

Created 8 June 2024 07:33:46 by sgu

Updated 8 June 2024 07:55:28 by sgu