

# 7.0 Settings

- 7.1 Automatic App Lock
- 7.2 Driving Mode
- 7.3 Diagnostic Data
- 7.4 Light Theme
- 7.5 Siri

# 7.1 Automatic App Lock

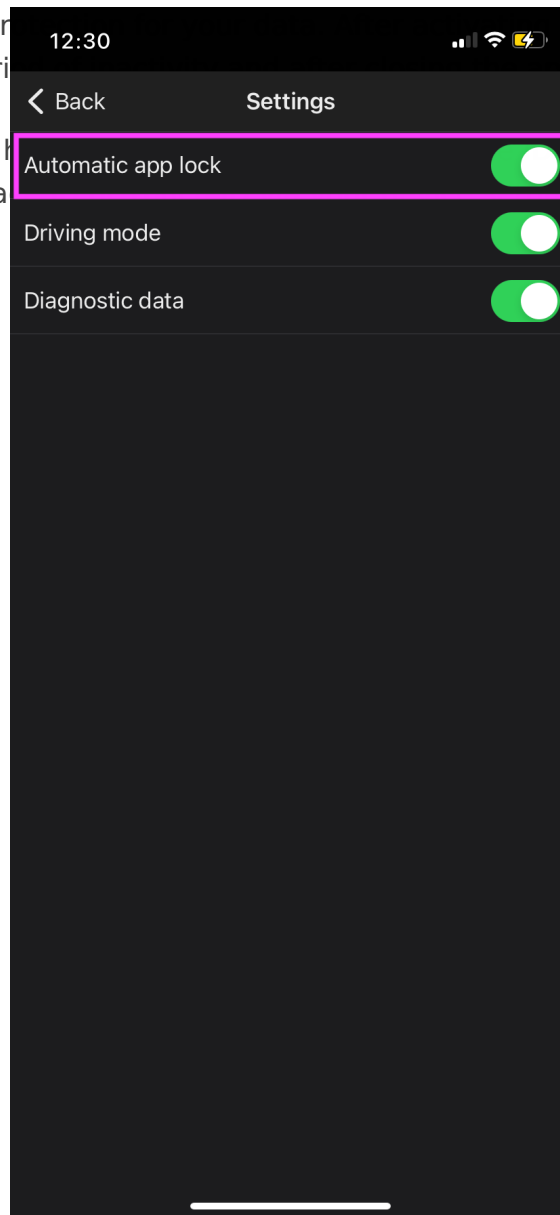
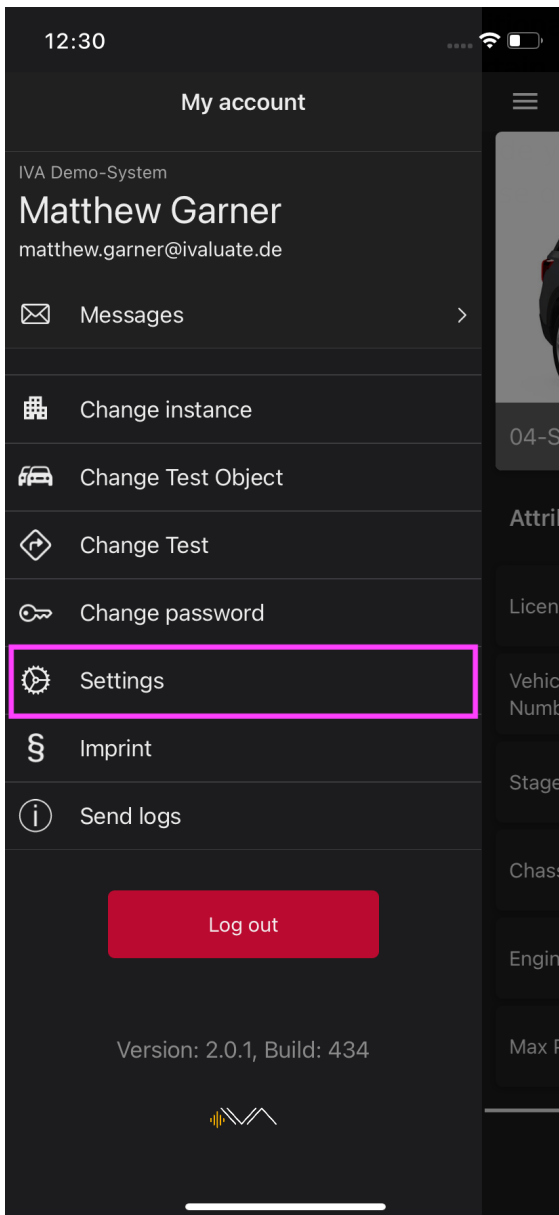

his function, the  
D.  
or Touch ID. To  
gs.

## 7.2 Driving Mode

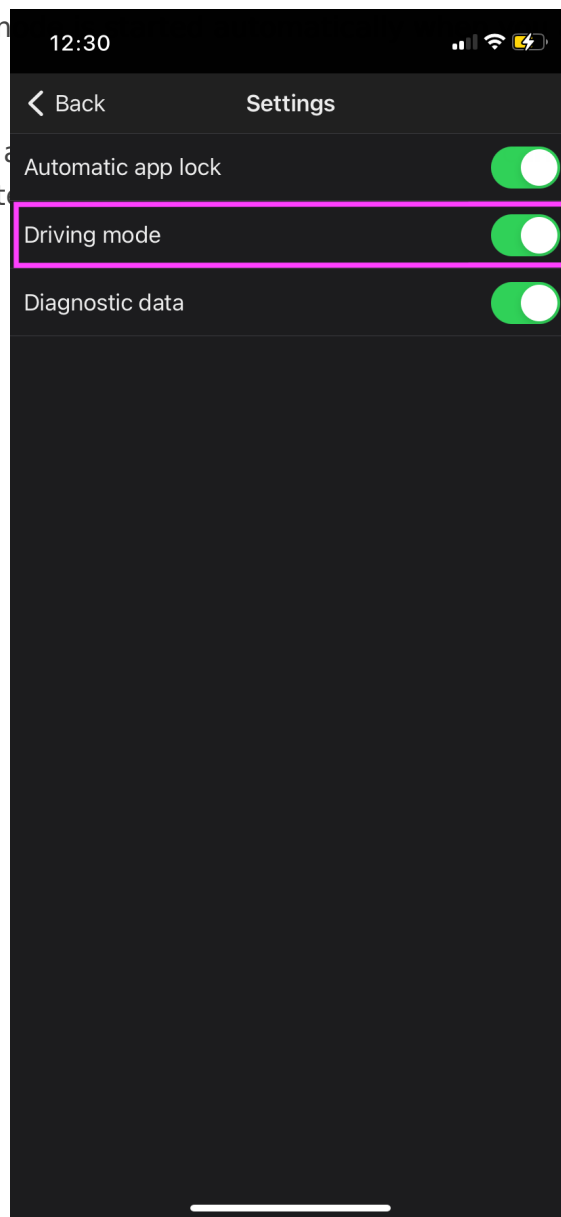
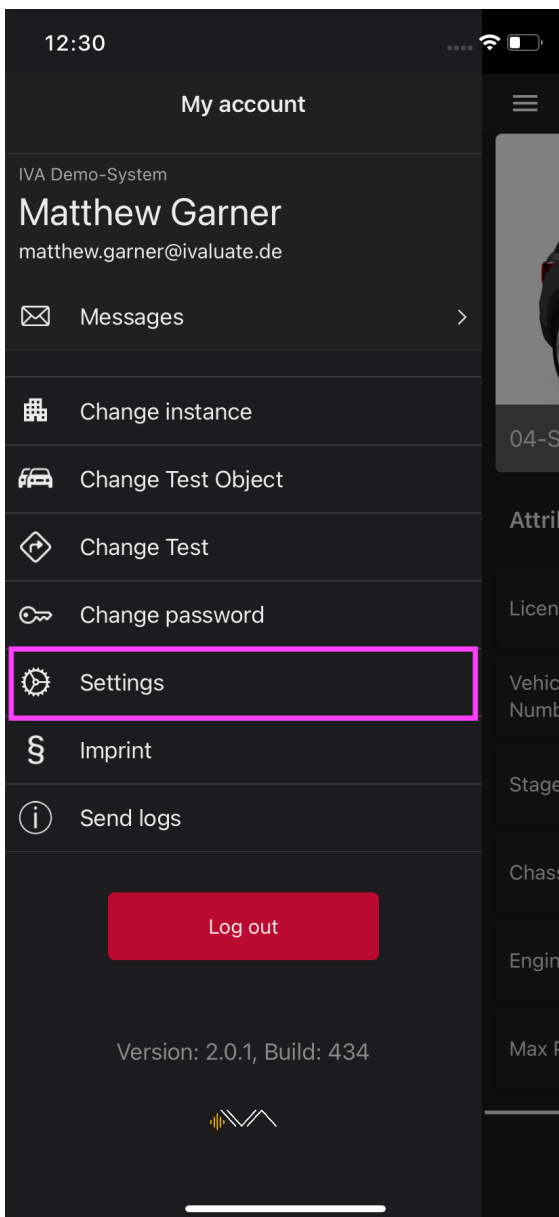

are in a moving

enter feedback

## 7.3 Diagnostic Data

By activating this function, you enable us to use data from your IVA app and your device for analysis purposes. With the help of this analysis data, for example information on system errors, we can continuously improve IVA and identify specific errors in the app.

To share your device's analytics data with us, the following steps are also necessary:

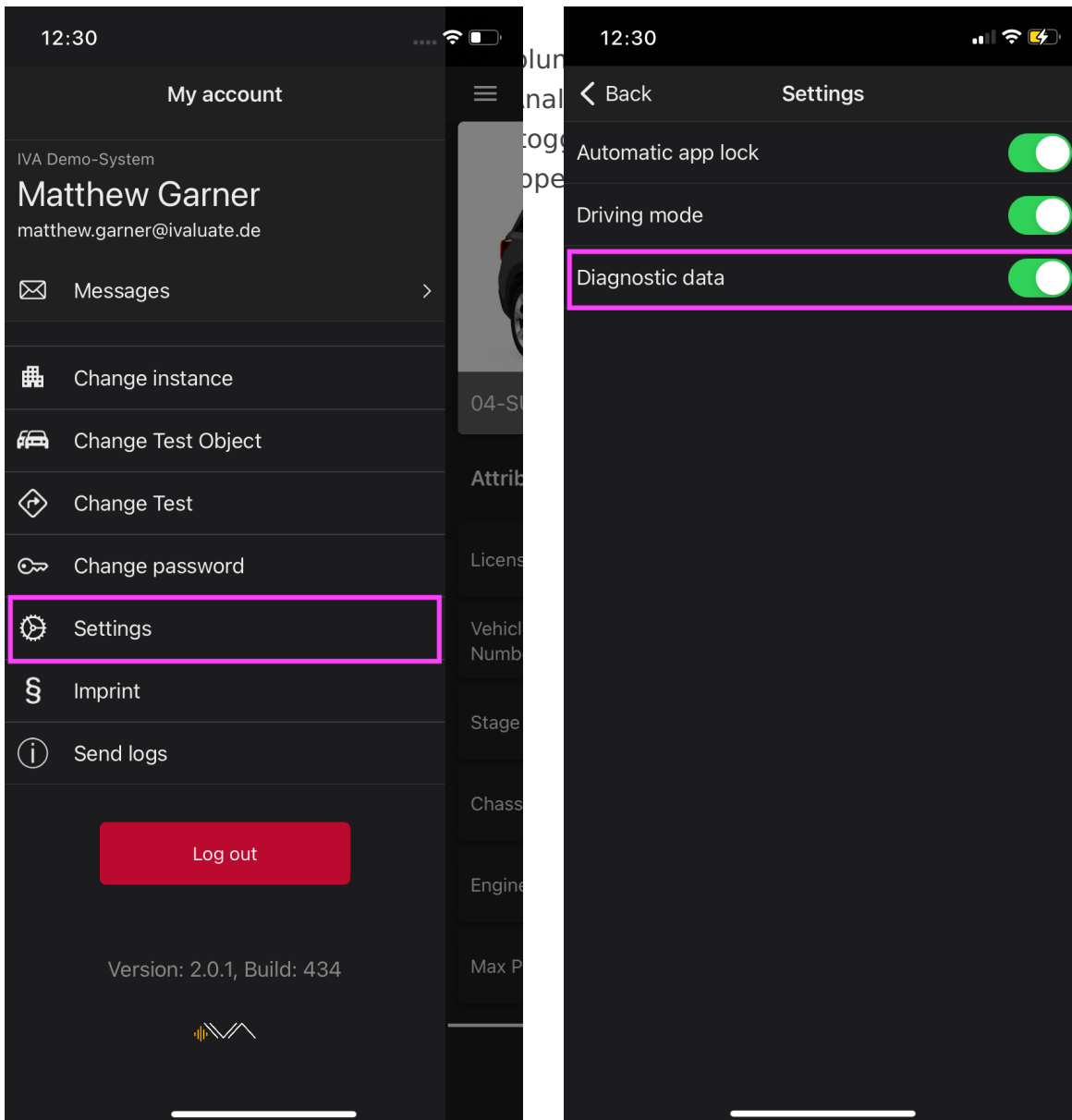



## 7.4 Light Theme

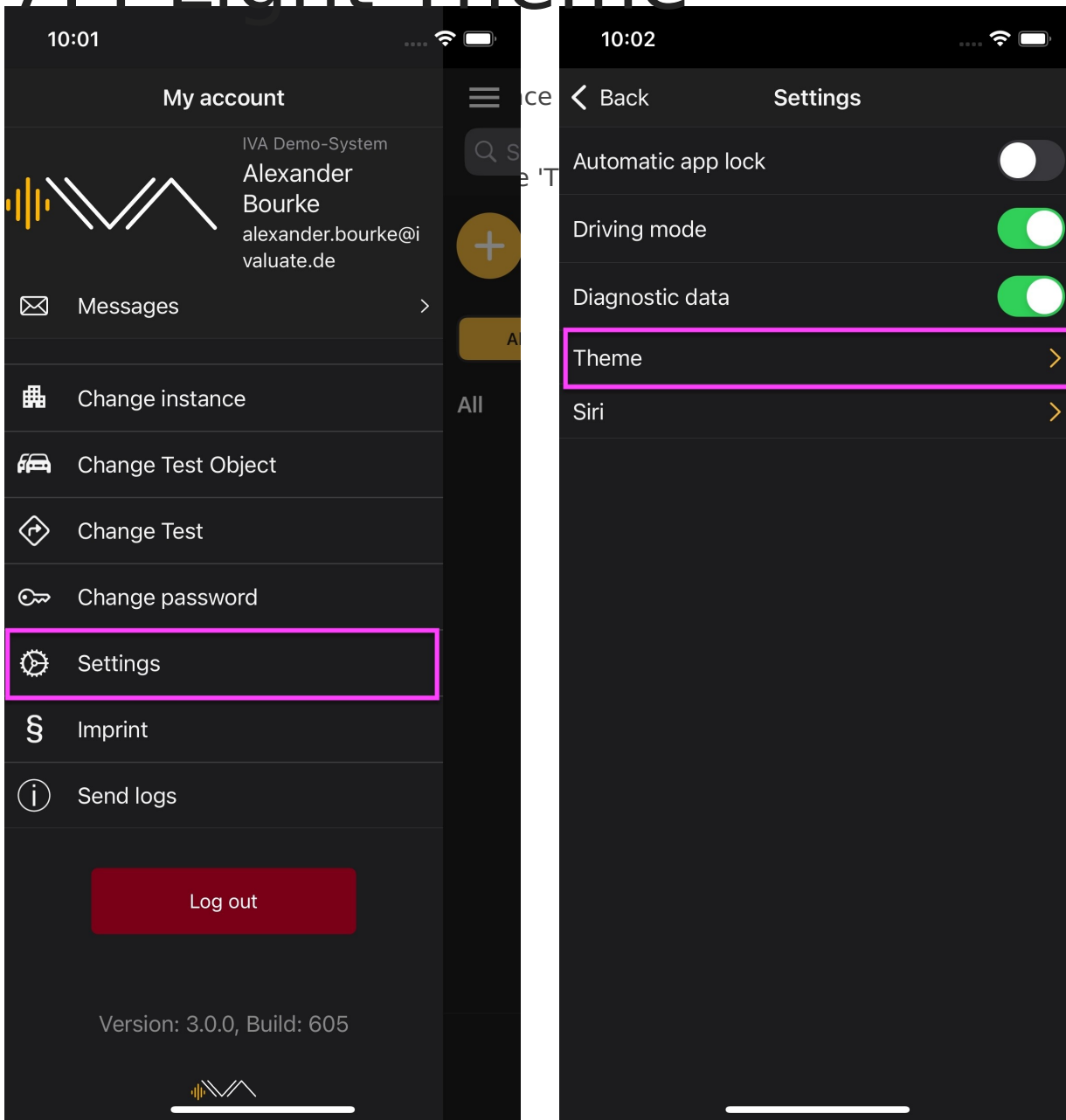

By clicking on it, the following three tabs will appear:

1. Automatic – the appearance adjusts to the iOS device's settings.
2. Light
3. Dark

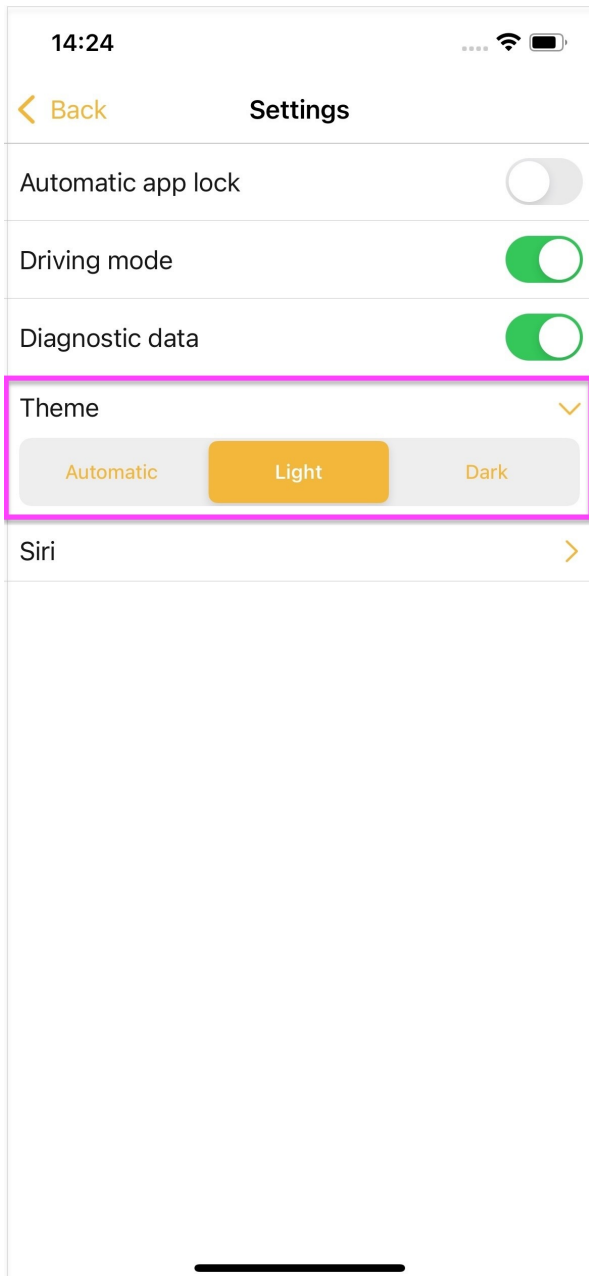

After selecting a tab, the appearance of the app will change."

# 7.5 Siri

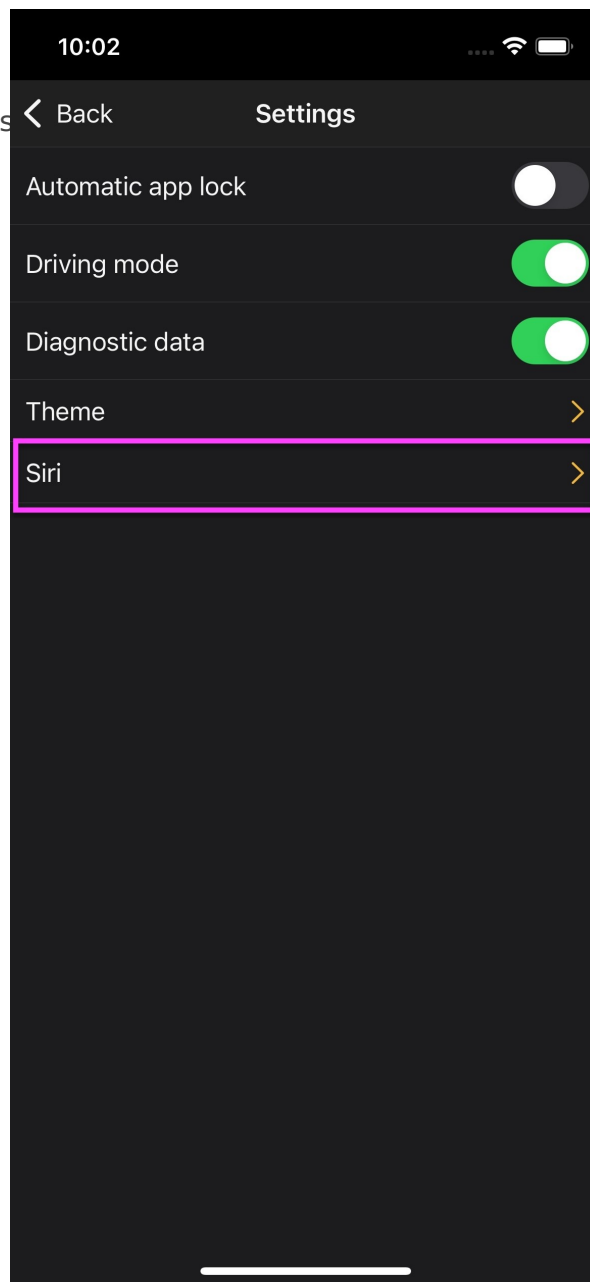
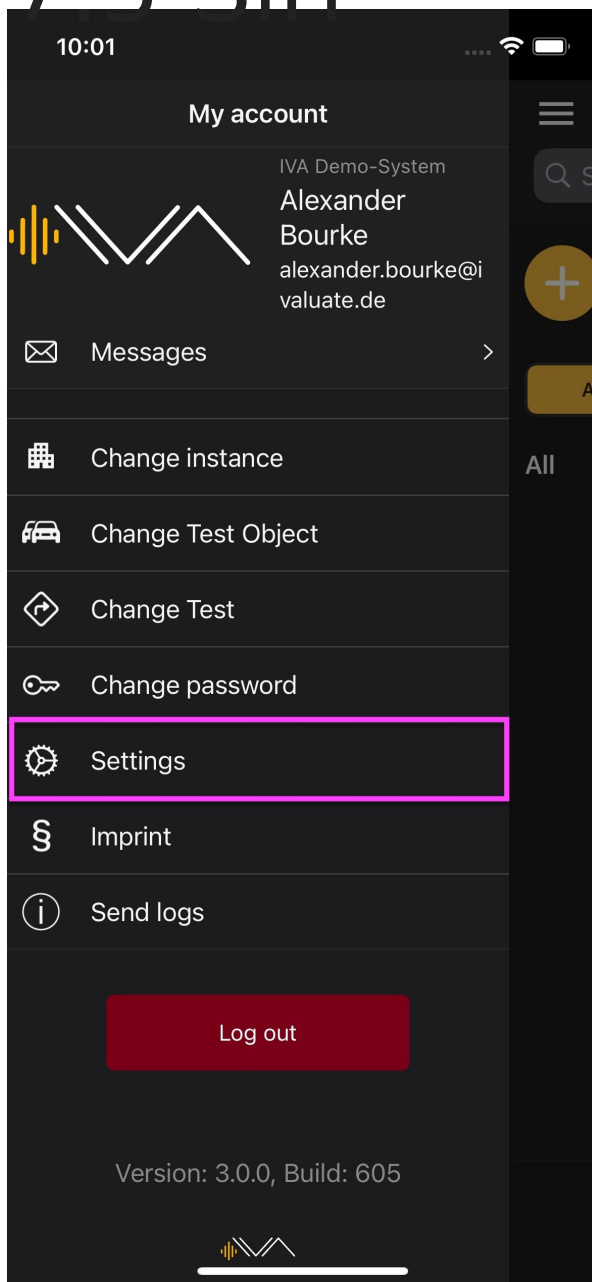

Optionally, you can enable the toggle "Ask Siri about categories," so Siri will ask you about the category in the future.



10:02



< Back

Settings

Automatic app lock ☐

Driving mode ☒

Diagnostic data ☒

Theme >

Siri ✓

Ask for Category ☒